

ULTRA70

MOTION PICTURE SYSTEM

TM

3X65
camera

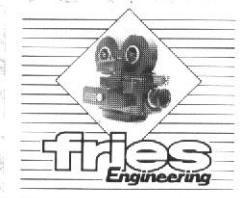

3X65 HORIZONTAL FORMAT
MOTION PICTURE CAMERA

OPERATING INSTRUCTIONS

Fries Engineering, Inc.
12032 Vose Street
North Hollywood
California 91605

Phone (818) 765-3600

Fax (818) 765-6977

my 1990

The 3X65 is a horizontal 15 perf 65mm motion picture camera, utilizing a spinning reflex mirror shutter, orientable viewfinder, video assist and 1000' displacement magazines. A follow focus and matte box with filter stages are standard for a full set of lenses from 30mm to 500mm.

To remove the camera from the case, fold-out handles are provided on both sides of the camera and convenient hand grips are machined into the magazine support plate.

The camera can be mounted directly to a head or an Arri 535 balance plate, with the two sets of mounting holes in the camera base. Three 3/8-16 holes are on optical centerline and used for general muting on most heads, etc. The other set of holes (two 3/8-16 and one 7.5mm) is for the Arri 535 system balance plate.

The matte box is the side swing away type that holds up to four filters 6.6"sq. x 3mm thick and one 138mm round in a rotating state. The four square filters are in two stages that can be individually rotated.

The follow focus attaches onto the built-in rods below the lens. Rod extensions screw into the stubs and hold the lens supports for the 30mm and the 500mm.

To mount the lenses, line up the white index line on the lens to the red dot on the body of the camera and insert the lens. Rotate the locking ring clockwise till tight.

Open the camera by loosening the two captive screws on the lid and lifting up. Under normal conditions, at the beginning of the shooting day, lubricate the points shown on the movement diagram

MOTOR SPECIFICATIONS

Power : 30VDC \pm 4 v

Frame Rate : 1 - 30FPS, Crystal control

operating Temp. Range: 0 F to 130 F

Power input connector, Bendix PC02A-12-3P.
Mating cable connector is Bendix PC06A-12-3S.
Pin A = **Positive**; Pin B = **Negative**.

Accessory connector, TMW R05-R8F.
Mating cable connector is TMW R05-PB8M.

ACCESSORY A

Pin A - +30VDC Out

B = SW 30V in (run/stop)

C = GND

D = Brake input (single-frame)

E = Shutter pulse out (12VPP @ .4MSEC duration)

F = Tach out (25 pulses/frame, 12VPP)

G = Ext. FPS input (300HZ=24FPS; 2VDC=24FPS)

H = Remote enable (+30V)

ACCESSORY B

Pin A = +30VDC out

B = SW 30V in (run/stop)

C = GND

E = Shutter pulse out (12VPP @ .4MSEC duration)

F = Tach out (25 **pulses/frame**, 12VPP)

Connect 30V battery to power connector on rear panel. A 15AMP circuit breaker on the same panel is also the main power switch. Push in for "ON" and pull out for "OFF". TO select forward or reverse insert a screwdriver into the recessed switch marked such, push in and turn 90 to the detent position F OR R.

CAUTION: DO NOT CHANGE DIRECTION SWITCH WHILE MOTOR IS ON.

Select your speed by pressing the buttons on the crystal readout. The speeds are all crystal controlled from 2FPS to 30FES in increments of 1 FPS. The ready light indicates green when power is applied, motor is ready for operation. It indicates red if the buckle trip switch has been activated. The sync lamp indicates green when crystal speed has been attained. The footage display is an LCD type with 3V lithium memory battery (#2032).

The video assist is internally powered from the main 30V source. A control panel is located on the rear corner of the viewfinder housing. A green light indicates power with the on switch. A BNC connector provides video out on the same panel.

TOP VIEW

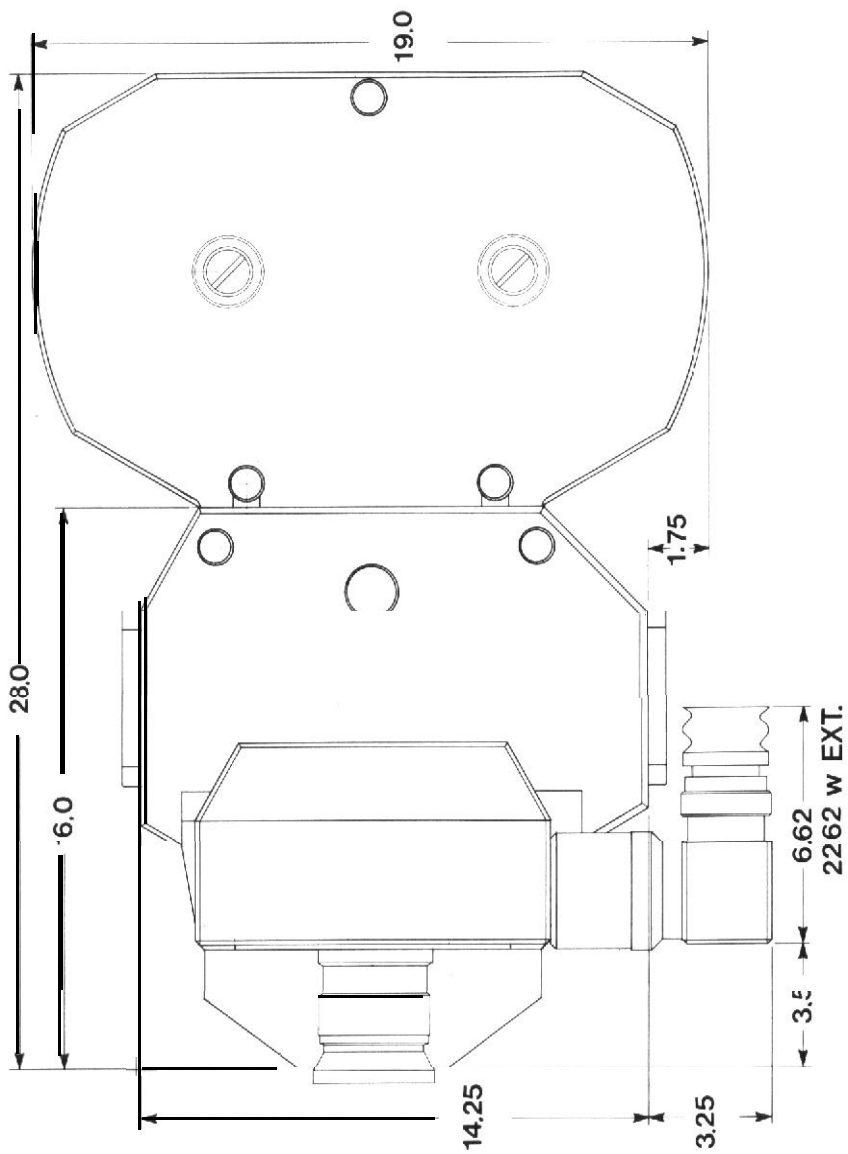

SIDE VIEW

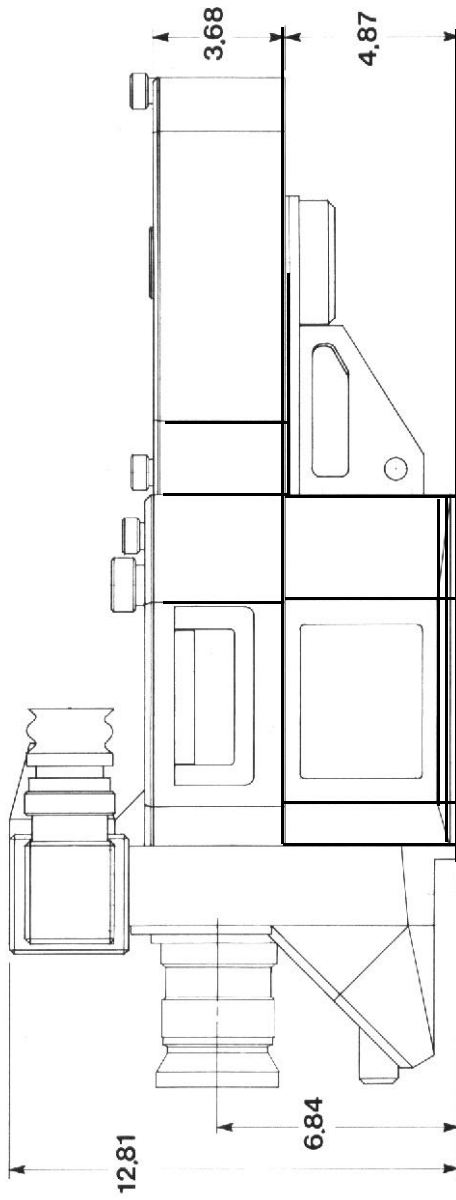

FRONT VIEW

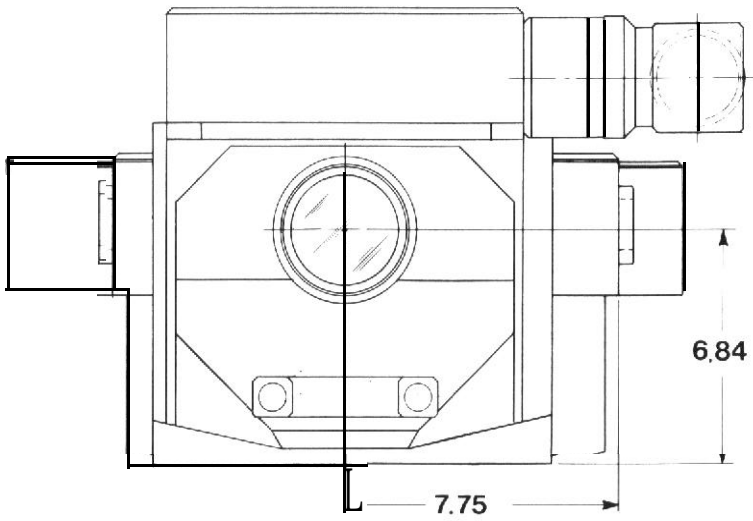

THREADING DIAGRAM

